

PANEL MOUNTING

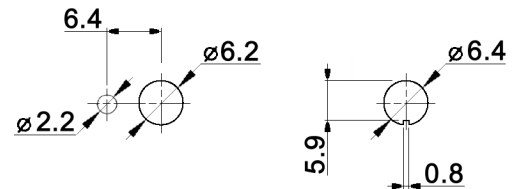

code for x	function	toggle towards keyway	toggle opposite to keyway
D	On-On	1-2, 4-5, 7-8	2-3, 5-6, 8-9

code for x	function	toggle towards keyway	toggle in center	toggle opposite to keyway
E	On-Off-On	1-2, 4-5, 7-8	open	2-3, 5-6, 8-9
EA	On-On-On	1-2, 4-5, 7-8	2-3, 4-5, 8-9	2-3, 5-6, 8-9

Specifications:

- Contact rating:** 3A, 250V AC / 6A, 125V AC
 4A, 30V DC / 5A, 12V DC
 6A, 6V DC
Contact resistance: 20mOhm max.
Insulation resistance: 1 000MOhm min. at 500V DC
Dielectric strength: 1 500V, 50Hz for the duration of 1 minute
Operating temperature: -45°C to +140°C
Mechanical life: 200 000 make-and-break cycles
Soldering conditions: hand-soldering: max.: 420°C, 3sec., 60W
 auto-soldering: max.: 270°C, 5sec.
Mounting instruction: max. torque: 49Ncm
Material: Terminal: brass, C1020 silver plated
 Case: DAP
 Housing: stainless steel, CNS9265
 Bushing: copper alloy, C3604BD nickel plated
 Actuator: copper alloy, C3604BD chrome plated
 Cap: aluminium
Included accessories: 2 pcs. nut M6x0.75, nickel plated, 9mm wrench size
 1 pc. tooth washer
 1 pc. locking washer
 Cap is not included

Compliance: RohS II (2011/65/EU)

Tolerances: 0.00: ±0.25mm 0.0: ±0.40mm	Date	Name	MTL 306 x	30 15 28	Page
	07/08	dr			
Revised	10/17	dr	knitter-switch	30 15 28	1/1
Modifications	Date	Name			